

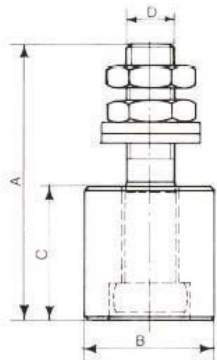







Materiale: Perno acciaio zincato



-  *Galvanized steel guide cylindrical roller, nylon or brass*
-  *Rouleau guide en acier zingué avec olive cylindrique en nylon ou laiton*
-  *Guiador en acero cincado con rodillo cilindrico de nylon o latón*
-  *Направляющий ролик*
-  *Führungsrolle aus verzinktem Stahl mit zylindrische Rolle aus Nylon oder Messing.*



Art.	Var.	A	B	C	D	Peso(g)	Conf.	
-	Variation	-	-	-	-	Weight(g)	Pack	
154/1.2	Nylon	74	30	40	M14	160	30	
154/2.2	Nylon	81	40	40	M14	250	25	
154/3.2	Nylon	109	40	60	M16	290	30	
154/1.3	Ottone Brass	74	30	40	M14	310	30	
154/2.3	Ottone Brass	81	40	40	M14	520	25	
154/3.3	Ottone Brass	109	40	60	M16	710	20	
<b>INOX</b>	<b>1154/2.2</b>	Nylon	81	40	40	M14	250	25
<b>INOX</b>	<b>1154/2.3</b>	Ottone Brass	81	40	40	M14	520	25

**Per oliva in nylon bianca indicare dopo il codice la lettera "B" Es. 154/1.2B**

**To order white cylindrical roller, add "B" at the end of the code. Ex.: 154/1.2B**