

# VB/FP

## Volantino a 6 lobi Six-lobe knob / Volante de seis lóbulos



### Descrizione

**Bussola in ottone e foro passante filettato. Sottotesta pieno.**  
Brass insert with tapped through hole. Filled knob.  
Inserto de latón y agujero pasante roscado. Volante lleno.

### Materiale

**Duroplasto nero.**  
Black phenolic plastic.  
Duroplástico negro.

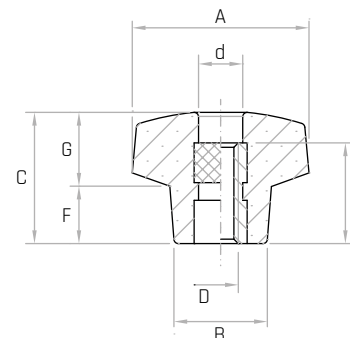

Codice	Modello	A mm	B mm	C mm	D	E mm	F mm	G mm	d mm	Peso gr.
6114002	<b>VB/20/FP M4</b>	20	13	15	<b>M4</b>	11	7	8	Ø7,5	6
6114003	<b>VB/20/FP M5</b>	20	13	15	<b>M5</b>	11	7	8	Ø7,5	7
6114005	<b>VB/20/FP M6</b>	20	13	15	<b>M6</b>	11	7	8	Ø7,5	10
6114010	<b>VB/30/FP M5</b>	30	17	24	<b>M5</b>	15	11	12,5	Ø9	15
6114015	<b>VB/30/FP M6</b>	30	17	24	<b>M6</b>	15	11	12,5	Ø9	16
6114020	<b>VB/30/FP M8</b>	30	17	24	<b>M8</b>	15	11	12,5	Ø9	17

**NOTE:** Si forniscono, per quantità adeguate, con inserti a misura in acciaio, in ottone, in acciaio inox.

For certain minimum quantities tapped metal inserts available in brass, zinc plated steel or stainless steel upon request.

Por cantidad apropiada, disponible también con insertos de distintas medidas.