

SCHEDA TECNICA

**PARIDE**

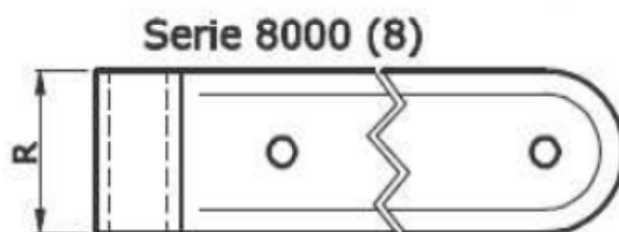

BANDELLA ZANCATA LUNGA\_226

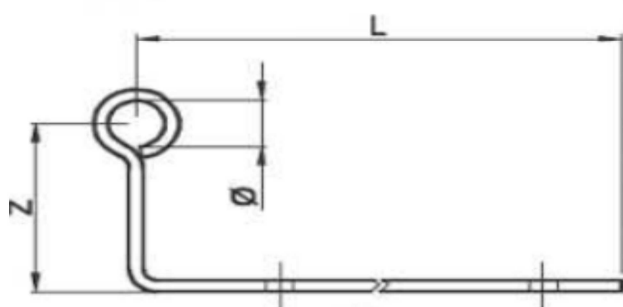

Articolo	Ø	L	R	th	Z	N.fori	Pz/conf.	Cataforesi + vern. nero	Iridizzato o zinc. bianco
<b>BANDELLE DRITTE Ø10 - Zanca corta, media, lunga</b>									
_2060025C#	10	27	35	3	35	4	24		
_2060030C#	10	32	35	3	35	4	24		
_2060025M#	10	26	35	3	45	4	24		
_2060030M#	10	31	35	3	45	4	24		
_2060025L#	10	24,5	35	3	60	4	24		
_2060030L#	10	29,5	35	3	60	4	24		

<b>BANDELLE DRITTE Ø12 - Zanca corta, media, lunga</b>									
_2260020C#	12	21,5	35	3	35	3	24		
_2260025C#	12	26,5	35	3	35	4	24		
_2260030C#	12	31,5	35	3	35	4	24		
_2260020M#	12	20,5	35	3	45	3	24		
_2260025M#	12	25,5	35	3	45	4	24		
_2260030M#	12	30,5	35	3	45	4	24		
_2260020L#	12	19	35	3	60	3	24		
_2260025L#	12	24	35	3	60	4	24		
_2260030L#	12	29	35	3	60	4	24		
_2260021C#	12	21,5	40	4	35	3	24		
_2260026C#	12	27	40	4	35	4	24		
_2260031C#	12	31,5	40	4	35	4	24		
_2260035C#	12	37	40	4	35	4	12		
_2260040C#	12	42	40	4	35	4	12		
_2260045C#	12	47	40	4	35	5	12		
_2260055C#	12	57	40	4	35	5	12		
_2260021M#	12	20,5	40	4	45	3	24		
_2260026M#	12	26	40	4	45	4	24		
_2260031M#	12	30,5	40	4	45	4	24		
_2260035M#	12	36	40	4	45	4	12		
_2260040M#	12	41	40	4	45	4	12		
_2260045M#	12	46	40	4	45	5	12		
_2260055M#	12	56	40	4	45	5	12		
_2260021L#	12	19	40	4	60	3	24		
_2260026L#	12	24,5	40	4	60	4	24		
_2260031L#	12	29	40	4	60	4	24		
_2260035L#	12	34,5	40	4	60	4	12		
_2260040L#	12	39,5	40	4	60	4	12		
_2260045L#	12	44,5	40	4	60	5	12		
_2260055L#	12	54,5	40	4	60	5	12		